

BS RJ45G 48(A)

Basic circuit diagram:

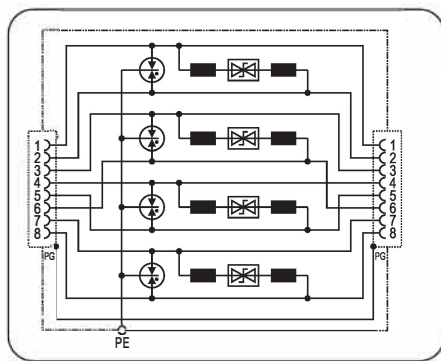

• Technical data

| | | |
|--|-----------|--|
| Type | | BS RJ45G 48(A) |
| Art.-No. | | 630 014 |
| Nominal voltage | U_N | 48V- |
| Rated voltage (max. continuous voltage) | U_C | 48V- / 34V ~ |
| Max. continuous voltage (PoE) | U_C | 58V- |
| Nominal current | I_L | 1.0A |
| D1 Lightning impulse current (10/350) | I_{imp} | 0.5/4kA (line-PG) |
| C2 Nominal discharge current (8/20) | I_n | 0.15kA (line-line) 2.5kA (line-PG) |
| C2 Total nominal discharge current (8/20) | I_n | 10kA |
| C2 Nominal discharge current (8/20) (PoE) | I_n | 0.15kA (pair-pair) |
| Voltage protection level at I_n C2 | U_p | ≤ 190V (line-line) ≤ 600V (line-PG) |
| Voltage protection level at I_n C2 (PoE) | U_p | ≤ 600V (line-line) |
| Transmission frequency | f_G | 250MHz |
| Data transmission rates | V_s | 1000Mbit/s |
| Insertion loss at 250MHz | a_E | ≤ 2dB |
| Capacitance | C | ≤ 165pF (line-line) ≤ 255pF (line-PG) |
| Operating temperature range | | -40°C...+80°C |
| Connection | | RJ45 shield (input / output) |
| Earthing via | | Screw terminal |
| Mounting on | | 35mm DIN rail |
| Enclosure material | | Aluminum |
| Test standards | | IEC 61643-21; EN 61643-21; GB/T 18802.21 |
| Certification | | CE |

• Product introduction

1. Summary

BS RJ45G 48(A) is for installation at LZW 0_b-2 and higher interface or directly installed near the equipment; according to IEC standard for CAT 6 or Class E integrated wiring system; all the industrial Ethernet 10M, 100M, 1Gbit network surge protection. Applicable to IEEE 802.3af/at/bt.

2. Main character

- Ideally suited for retrofitting, protection of all lines
- Cat.6 in the channel (class E)
- Power over Ethernet IEEE 802.3 compliant (up to PoE++ /4PPoE)
- For installation in conformity with the lightning protection zone concept at the boundaries from 0_b-2 and higher.
- Good discharge capacity, low voltage protection level
- Quick response, high transmission speed, low signal attenuation
- Fully shielded RJ45 socket, 35mm standard guide rail, easy to install

3. Application

BS RJ45G 48(A) is applied in offices and industrial Ethernet like Gigabit Ethernet, ATM, FDDI or ISDN system, and like VoIP or PoE system can be protected. (e.g. Switch, router, HUB, modem and so on) , for Industrial Ethernet, Compliant with PoE power supply (IEEE 802.3 compliant up to PoE++ / 4PPoE) and similar application in structured cabling systems according to class E up to 250 MHz.

4. Application environment

- Temperature: -40°C ~ +80°C
- Relative humidity: ≤ 95% (25°C)

• Installation instruction

1. This product is connected in series to the protected device.
2. Mount the SPD on 35 mm DIN rail.
3. The OUT terminal should be connected to the protected devices.
4. SPD's earthing terminal must be connected to nearby earthing BusBar or the metal earthing enclosure of the protected device.
5. After above, you should ensure the circuit is functioning.

Regularly inspect the operating status, especially after lightning.

Once the communication is off, electrician should check/replace the SPD.

BS RJ45G 48(A) installation diagram :

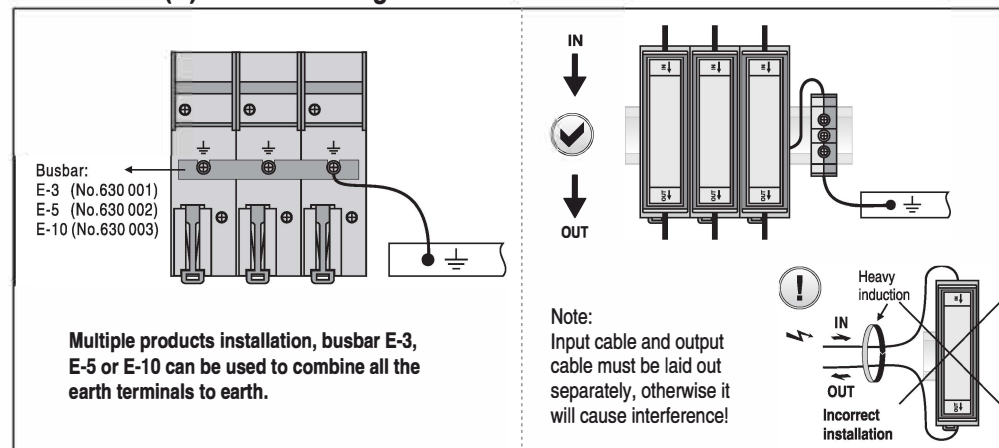

WARNING:

1. The device must be installed by electrically skilled person, conforming to national standards and safety regulations.
2. It is recommended that installation should be done under power off condition.