

CABLE TIES ACCESSORIES

CABLE TIES SUPPORTS

Applications

Fixing of cables and pipes.
Installation temperature: > -5°C
Operating temperature: -10°C ÷ 65°C

Characteristics

Polyamide 6 black (carbon black).
Available in black and white colours
(characteristics on page 19).

Benefits

Very easy installation: for cable ties up to 9 mm width. Two different types for different wall distances.

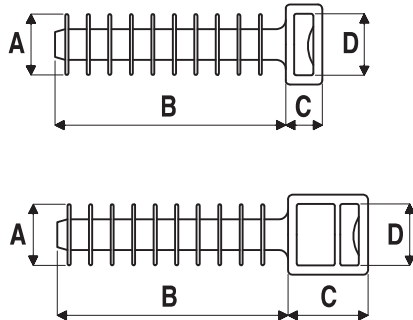

WALLPLUG BASES FOR CABLE TIES polyamide 6

Code	Code	Ø Hole (mm)	Dimensions (mm)				Bag pcs	Carton pcs
			A	B	C	D		
5456 AE	5456 AWE	6	7,8	30,7	6,3	9,6	100	5.000
5458E	5458 WE	8	10,0	37,0	6,5	9,7	100	5.000
5458 AE	-	8	10,0	37,0	6,5	9,7	100	5.000
5459E	-	8	10,0	37,0	13	9,7	100	4.000

* Grey colour on request.

Applications

Fixing of cables and pipes.

Characteristics

Polyamide 6.6 black (carbon black).
The support is provided with M6/7 thread, can therefore be fixed with plug cod. 566112.
(characteristics on page 19)

Benefits

For cable ties up to 9 mm width. Suitable for either countersunk or flat headed screws.
For wall plug max 8 mm.

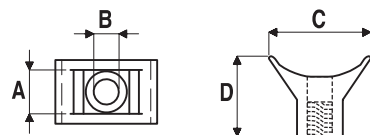

CABLE TIE SUPPORT in polyamide 6.6 for cable ties width up to 9 mm

Code	Dimensions (mm)				Thread	Bag pcs	Carton pcs
	A	B	C	D			
1041301E	9,4	5	23	17,6	M6/7	100	10.000



THREADED WALL PLUG M6/7 in polyamide 6.6 for cable tie support

Code	Length (mm)	Ø Hole (mm)	Thread	Bag pcs	Carton pcs



Applications

Characteristics

Benefits

Fixing of cables and pipes.

Polyamide 6.6 black (carbon black).
(characteristics on page 19)

Fast fixing with hammer-in anchor
(our UCX Ø 5x36 mm).
For cable ties up to 9 mm width.



CABLE TIE SUPPORT in polyamide 6.6 with anchor

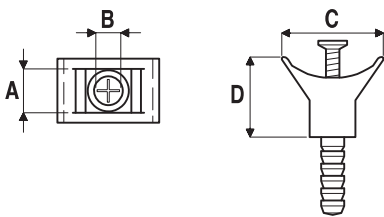

Code	Dimensions (mm)				Bag pcs	Carton pcs
	A	B	C	D		
1041303	9,4	5	23	17,6	100	10.000

Applications

Characteristics

Benefits

Electrical panels.

Polyamide 6.6.
(characteristics on page 19)
For cable ties width max 9 mm.

Fixing with screw or rivet.



CRADLES IN POLYAMIDE 6.6

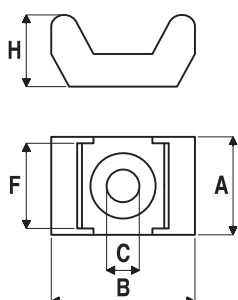

Code Natural	Code Black	Cable ties width (mm)	Dimensions (mm)					Bag pcs	Carton pcs
			A	B	C	F	H		
5498	5499	5	9,5	15	3,5	5	7	100	10.000
5496E	5497E	9	14,6	22,5	5	9,3	11	100	5.000